



PVC & CPVC LAB VALVES

LV-2-0804

Laboratory and Specialty Valve



Multi-Function 1/4" Lab Valve with Adapter Kit

Kit includes PVC or CPVC 1/4" FIPT Valve, O-ring sealed male NPSM x MIPT Adapters, O-ring sealed male NPSM x 3/8" I.D. Tubing Adapters, EPDM or Viton® O-rings and Hex Wrench for quick assembly of adapters with valve.

Chemical and Corrosion Resistant PVC or CPVC Construction

Spears® Lab Valves never rust, scale or pit, providing exceptional chemical and corrosion resistance. Heat resistant CPVC allows higher temperature applications.

EPDM or Viton® O-ring Options

Choice of high grade, ozone resistant EPDM or Viton® elastomer O-rings allows application specific selection for optimum chemical resistance.

High Impact Polypropylene Handle

Features double stop engagement and exhibits excellent resistance to most chemical environments.

PTFE Ball Seats

Spears® PTFE floating seat design reduces seat wear for extended valve life, smooth operation and bubble-tight shut-off. 100% factory tested.

Full Schedule 80 Bore

In full open position, full bore virtually eliminates pressure drop, providing optimum flow.

Full 150 psi Pressure Rating

Maximum Internal Pressure at 73°F for the most demanding applications.

Suitable for Vacuum Service

Spears® Lab Valves are tested at 26 in. Hg vacuum for one hour with less than 1 in. Hg loss.

Individual 1/4" and 3/8" Specialty Valves

Small, compact socket or thread design without adapters allows a variety of O.E.M. and other special applications.

This versatile, quarter-turn shut-off valve is ideally suited for a variety of laboratory, system monitoring and OEM applications. Available in IPS sizes 1/4" and 3/8" with choice of socket or threaded end connectors. Optional 1/4" valve & adapter kit provides multiple combinations of tubing and male pipe thread connections.



For additional information, please refer to Spears® THERMOPLASTIC VALVES & ACCESSORIES PRODUCT GUIDE & ENGINEERING SPECIFICATIONS V-4 and THERMOPLASTIC VALVES & ACCESSORIES Price Schedule V-1.

Sample Engineering Specification

All thermoplastic valves shall be Lab type constructed from PVC Type I Cell Classification 12454 or CPVC Type IV Cell Classification 23447. All O-rings shall be EPDM, Viton®. All valves shall have double stop Polypropylene handle. All 1/4" valves shall have optional field installable male threaded and tubing end connector adapters. All valves shall be pressure rated at 150 psi for water at 73°F, as manufactured by Spears® Manufacturing Company.



Quality Systems Certificate No. 293
Corporate Facilities, Sylmar, CA
Assessed to ISO 9001: 2000

Teflon and Viton® are registered trademarks of E.I. du Pont de Nemours & Co.

Quick-View Valve Selection Chart

C_v Values

PVC PART NUMBER ¹					
Valve Size	O-ring Material	Threaded	Socket	Threaded w/ Adapter Kit	Pressure Rating
1/4	EPDM	1521-002	1522-002	1529-002	150 psi Non-Shock Water @ 73°F
	Viton®	1531-002	1532-002	1539-002	
3/8	EPDM	1521-003	1522-003	N/A	
	Viton®	1531-003	1532-003	N/A	

Valve Size	C _v
1/4*	10*
3/8	24

* without adapters

Values calculated from valve laying length, based on derivative of Hazen-Williams equation with surface roughness factor of C=150.

1: For CPVC valves, add the "C" to part numbers listed (e.g., 1521-002C).

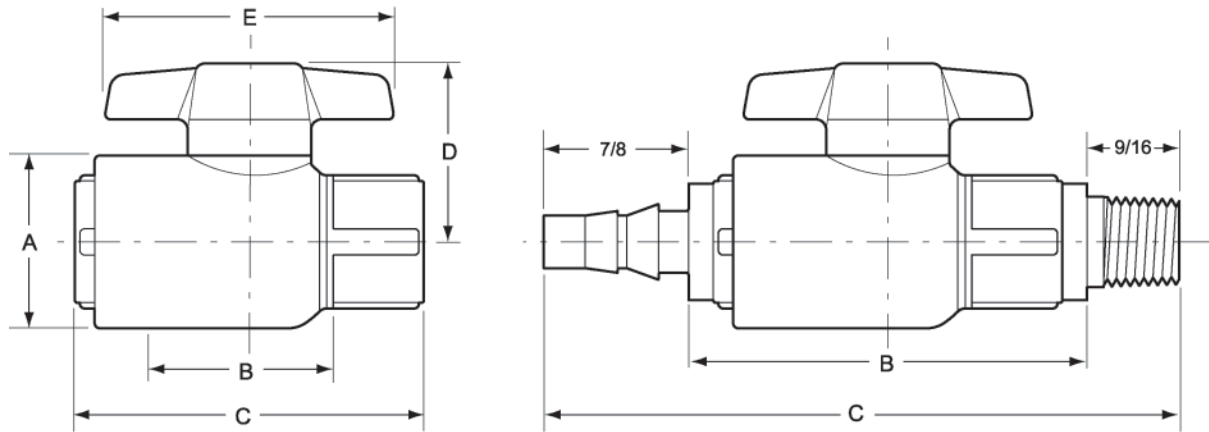

Dimensions, Weights & C_v Values

Nominal Size	Dimension Reference (inches, ± 1/16)					Approx. Wt. (Lbs.)		C _v ² Values
	A	B ¹	C	D	E	PVC	CPVC	
1/4	1-1/16	15/16	2-1/8	1-1/16	1-3/4	.10	.11	10
1/4 w/Kit	1-1/16	2-7/16	3-7/8	1-1/16	1-3/4	.14	.15	6
3/8	1-5/16	1	2-3/16	1-1/4	2	.12	.13	24

1: Valve Lay Length

2: Gallons per minute at 1 psi pressure drop. Values calculated from valve laying length, based on derivative of Hazen-Williams equation with roughness factor of C=150.

Temperature Pressure Rating

System Operating Temperature °F (°C)		73 (23)	100 (38)	110 (43)	120 (49)	130 (54)	140 (60)	150 (66)	160 (71)	170 (77)	180 (82)	190 (88)
Valve Pressure Rating psi (MPa)	PVC	150 (1.03)	124 (.85)	100 (.69)	75 (.52)	-0- (-0-)	-0- (-0-)	-0- (-0-)	-0- (-0-)	-0- (-0-)	-0- (-0-)	-0- (-0-)
	CPVC	150 (1.03)	140 (.97)	130 (.90)	120 (.83)	110 (.76)	100 (.69)	90 (.62)	80 (.55)	70 (.48)	60 (.41)	-0- (-0-)

NOTE: Threaded Valves should not be used at temperatures above 110°F (43°C) for PVC, and 150°F (66°C) for CPVC.

Authorized Distributor:

Aetna Plastics Corp. 1702 St. Clair Ave. Cleveland, Ohio 44114 • Tel: 800-634-3074
216-781-4421 • Fax: 216-781-4474 • sales@aetnaplastics.com • www.aetnaplastics.com