

**TRUE UNION CHECK VALVES - BALL SERIES**

**FEATURES**

- 100% factory tested.
- Easy installation and maintenance.
- May be used either vertically and horizontally.
- Available in PVC and Corzan® CPVC.
- Socket, threaded and foot valve screen end connectors included.
- Resistance to many inorganic chemicals.
- Excellent flow characteristics.
- Sizes from 1/2" to 4".
- Available standards: ANSI/ASTM, Metric, British Standard.
- Threaded versions: NPT and BSP.
- O-rings available in EPDM or Viton®.
  
- Minimum return pressure: 3 psi.

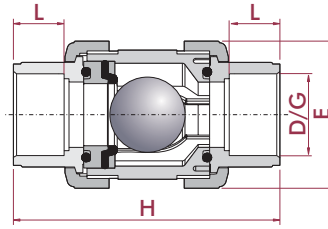

D / G	L	H	E
1/2"	0.6"	3.3"	2.0"
3/4"	0.7"	4.3"	2.4"
1"	0.9"	4.7"	2.8"
1 1/4"	1.0"	5.6"	3.3"
1 1/2"	1.2"	6.4"	3.7"
2"	1.5"	7.6"	4.6"
2 1/2"	1.7"	9.1"	5.8"
3"	2.0"	10.6"	7.0"
4"	2.4"	11.0"	7.0"

Fig.	Parts	Material
1	Body	PVC / CPVC
3	Ball	PVC / CPVC
4	Union nut	PVC / CPVC
5	End connector	PVC / CPVC
6	Closing ring	PVC / CPVC
7	Body o-ring	EPDM / FPM
8	End connector o-ring	EPDM / FPM
9	Seal carrier	PVC / CPVC
10	Foot valve screen	PPL

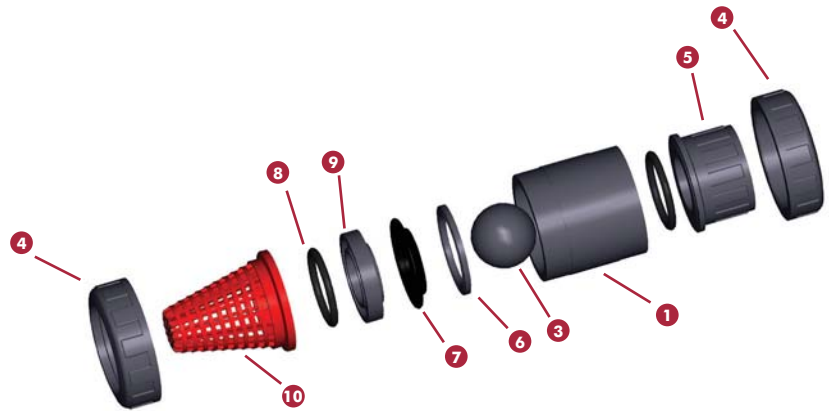

D / G	Kv <sub>100</sub>	Cv
1/2"	99	7
3/4"	128	9
1"	308	22
1 1/4"	453	32
1 1/2"	795	56
2"	1040	73
2 1/2"	1932	135
3"	2754	193

$Cv = Kv_{100} / 14,28$   
 $Kv_{100}$  (l/min, Δp = 1 bar)  
 $Cv$  (GPM, Δp = 1 psi)

**PRESSURE-TEMPERATURE RELATIONSHIP GUIDE**

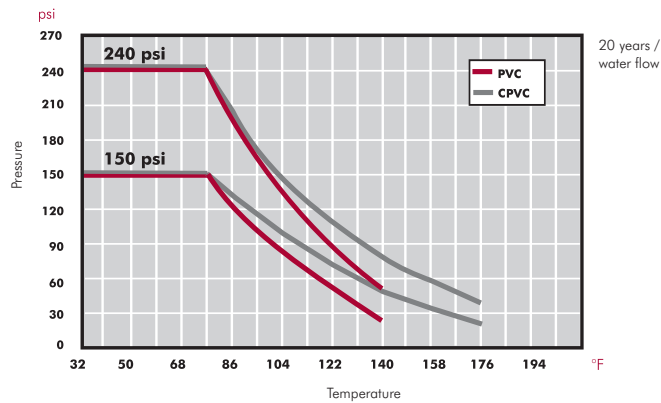

**TOTAL DYNAMIC HEAD**

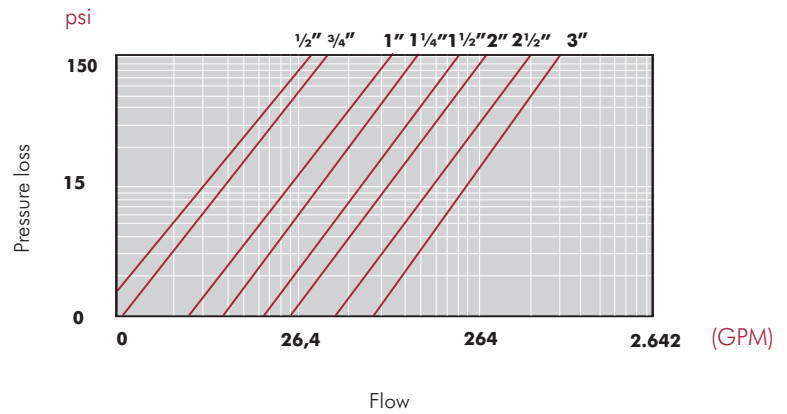

**PVC True Union Check Valves - Ball Series - EPDM**



**PVC TRUE UNION**  
**Threaded and socket**  
 O-rings: EPDM  
 240 psi @ 73°F



**PVC TRUE UNION**<sup>1</sup>  
 O-rings: EPDM  
 150 psi @ 73°F



Size	Reference	psi	Pack	Weight (lb)	Q	Code
1/2"	05 67 801 ED	240	B	4.00	8 (1)	<b>27360</b>
3/4"	05 67 802 ED	240	B	6.05	8 (1)	<b>27361</b>
1"	05 67 803 ED	240	B	4.53	4 (1)	<b>27362</b>
1 1/4"	05 67 804 ED	240	B	6.71	4 (1)	<b>27363</b>
1 1/2"	05 67 805 ED	240	D	18.70	8 (1)	<b>27000</b>
2"	05 67 806 ED	240	D	23.32	6 (1)	<b>27001</b>

**THREADED**

Size	Reference	psi	Pack	Weight (lb)	Q	Code
2 1/2"	05 67 807 E	150	D	25.43	4 (1)	<b>27368</b>
3"	05 67 808 E	150	D	21.98	2 (1)	<b>27369</b>
4" <sup>3</sup>	05 67 810 E	150	D	24.64	2 (1)	<b>27370</b>

**SOCKET**

Size	Reference	psi	Pack	Weight (lb)	Q	Code
2 1/2"	05 67 907 EMA	150	D	25.52	4 (1)	<b>27374</b>
3"	05 67 908 EMA	150	D	21.52	2 (1)	<b>27375</b>
4" <sup>3</sup>	05 67 910 EMA	150	D	23.76	2 (1)	<b>27376</b>

**PVC True Union Check Valves - Ball Series - Viton®**



**PVC TRUE UNION**  
**Threaded and socket**  
 O-rings: FPM (Viton®)  
 240 psi @ 73°F



**PVC TRUE UNION**<sup>1</sup>  
 O-rings: FPM (Viton®)  
 150 psi @ 73°F



Size	Reference	psi	Pack	Weight (lb)	Q	Code
1/2"	05 67 801 VED	240	B	4.04	8 (1)	<b>27364</b>
3/4"	05 67 802 VED	240	B	6.12	8 (1)	<b>27365</b>
1"	05 67 803 VED	240	B	4.58	4 (1)	<b>27366</b>
1 1/4"	05 67 804 VED	240	B	6.78	4 (1)	<b>27367</b>
1 1/2"	05 67 805 VED	240	D	18.91	8 (1)	<b>27002</b>
2"	05 67 806 VED	240	D	23.51	6 (1)	<b>27003</b>

**THREADED**

Size	Reference	psi	Pack	Weight (lb)	Q	Code
2 1/2"	05 67 807 VE	150	D	25.72	4 (1)	<b>27371</b>
3"	05 67 808 VE	150	D	22.23	2 (1)	<b>27372</b>
4" <sup>3</sup>	05 67 810 VE	150	D	24.92	2 (1)	<b>27373</b>

**SOCKET**

Size	Reference	psi	Pack	Weight (lb)	Q	Code
2 1/2"	05 67 907 VEMA	150	D	25.81	4 (1)	<b>27377</b>
3"	05 67 908 VEMA	150	D	20.90	2 (1)	<b>27378</b>
4" <sup>3</sup>	05 67 910 VEMA	150	D	24.03	2 (1)	<b>27379</b>

<sup>1</sup> 1/2" thru 2" Ball Valves are supplied with both socket and threaded end connectors.

<sup>2</sup> 1/2" thru 4" Ball Valves have to be ordered with socket or threaded connections, they don't include both.

<sup>2</sup> Check Valves are supplied with a foot valve screen; used to convert true union ball check valves into foot valves.

<sup>3</sup> 3" double union body venturied to 4"

**CORZAN® CPVC True Union Check Valves - Ball Series - EPDM**

**CPVC TRUE UNION**  
**Threaded and socket**  
 O-rings: EPDM  
 240 psi @ 73°F

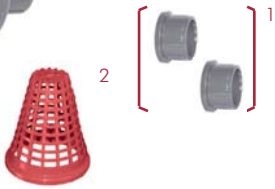

**CPVC TRUE UNION**<sup>1</sup>  
 O-rings: EPDM  
 150 psi @ 73°F



Size	Reference	psi	Pack	Weight (lb)	Q	Code
1/2"	35 67 801 ED	240	B	4.20	8 (1)	<b>27380</b>
3/4"	35 67 802 ED	240	B	6.35	8 (1)	<b>27381</b>
1"	35 67 803 ED	240	B	4.76	4 (1)	<b>27382</b>
1 1/4"	35 67 804 ED	240	B	7.05	4 (1)	<b>27383</b>
1 1/2"	35 67 805 ED	240	D	19.64	8 (1)	<b>27384</b>
2"	35 67 806 ED	240	D	24.49	6 (1)	<b>27385</b>

**THREADED**

Size	Reference	psi	Pack	Weight (lb)	Q	Code
2 1/2"	35 67 807 E	150	D	26.71	4 (1)	<b>27392</b>
3"	35 67 808 E	150	D	23.09	2 (1)	<b>27393</b>
4" <sup>3</sup>	35 67 810 E	150	D	25.88	2 (1)	<b>27432</b>

**SOCKET**

Size	Reference	psi	Pack	Weight (lb)	Q	Code
2 1/2"	35 67 907 EMA	150	D	26.81	4 (1)	<b>27397</b>
3"	35 67 908 EMA	150	D	22.60	2 (1)	<b>27398</b>
4" <sup>3</sup>	35 67 910 EMA	150	D	24.96	2 (1)	<b>27433</b>

**CORZAN® CPVC True Union Check Valves - Ball Series - Viton®**

**CPVC TRUE UNION**  
**Threaded and socket**  
 O-rings: FPM (Viton®)  
 240 psi @ 73°F



**CPVC TRUE UNION**<sup>1</sup>  
 O-rings: FPM (Viton®)  
 150 psi @ 73°F



Size	Reference	psi	Pack	Weight (lb)	Q	Code
1/2"	35 67 801 VED	240	B	4.24	8 (1)	<b>27386</b>
3/4"	35 67 802 VED	240	B	6.43	8 (1)	<b>27387</b>
1"	35 67 803 VED	240	B	4.81	4 (1)	<b>27388</b>
1 1/4"	35 67 804 VED	240	B	7.12	4 (1)	<b>27389</b>
1 1/2"	35 67 805 VED	240	D	19.86	8 (1)	<b>27390</b>
2"	35 67 806 VED	240	D	24.69	6 (1)	<b>27391</b>

**THREADED**

Size	Reference	psi	Pack	Weight (lb)	Q	Code
2 1/2"	35 67 807 VE	150	D	27.02	4 (1)	<b>27394</b>
3"	35 67 808 VE	150	D	23.35	2 (1)	<b>27395</b>
4" <sup>3</sup>	35 67 810 VE	150	D	26.17	2 (1)	<b>27396</b>

**SOCKET**

Size	Reference	psi	Pack	Weight (lb)	Q	Code
2 1/2"	35 67 907 VEMA	150	D	27.11	4 (1)	<b>27399</b>
3"	35 67 908 VEMA	150	D	21.95	2 (1)	<b>27400</b>
4" <sup>3</sup>	35 67 910 VEMA	150	D	25.24	2 (1)	<b>27401</b>

<sup>1</sup> 1/2" thru 2" Ball Valves are supplied with both socket and threaded end connectors.

<sup>2</sup> 1/2" thru 4" Ball Valves have to be ordered with socket or threaded connections, they don't include both.

<sup>2</sup> Check Valves are supplied with a foot valve screen; used to convert true union ball check valves into foot valves.

<sup>3</sup> 3" double union body venturied to 4"

Authorized Distributor:

**Aetna Plastics Corp. 1702 St. Clair Ave. Cleveland, Ohio 44114 • Tel: 800-634-3074  
 216-781-4421 • Fax: 216-781-4474 • sales@aetnaplastics.com • www.aetnaplastics.com**