

TRUE UNION BALL VALVES - NEWVAL SERIES

FEATURES

- “Antiblock” system that avoids ball blockage.
- 100% factory tested.
- Minimal pressure drop.
- Low operating torque.
- Resistance to many inorganic chemicals.
- Excellent flow characteristics.
- Sizes from 1/2" - 4".
- O-rings available in EPDM.
- Ball seat available in HDPE.

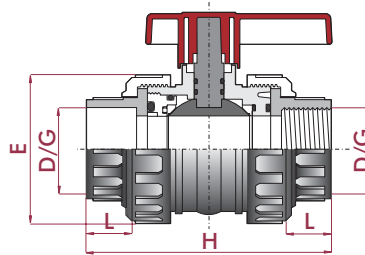

D / G	L	H	E
1/2"	0.6"	3.8"	1.9"
3/4"	0.7"	4.2"	2.3"
1"	0.9"	4.5"	2.7"
1 1/4"	1.0"	5.2"	3.2"
1 1/2"	1.2"	6.0"	3.7"
2"	1.5"	6.7"	4.3"
3"	2.0"	9.6"	5.8"
4"	2.3"	11.2"	7.0"

Fig.	Parts	Material
1	Body	PVC
2	Union nut	PVC
3	End connector	PVC
4	Handle	ABS
5	Ball	PVC
6	Stem	PVC
7	Seal carrier	PVC
8	Ball seat	HDPE
9	Stem o-ring	EPDM
10	Body o-ring	EPDM
11	End connector o-ring	EPDM

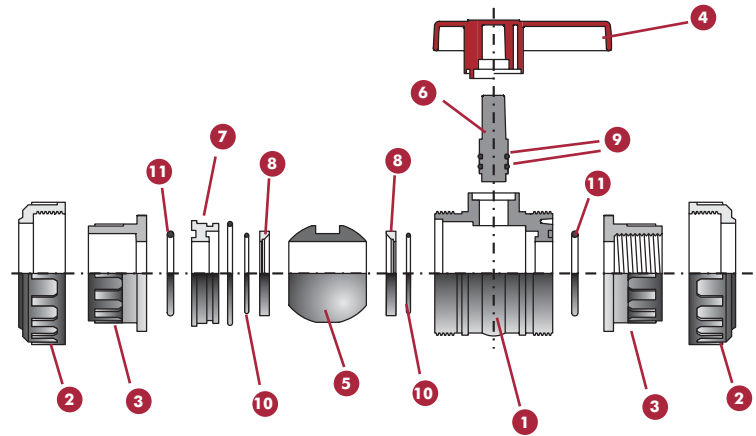

PVC TRUE UNION

Socket

Seats: HDPE
 O-rings: EPDM
 1/2" - 2" 240 psi @ 73°F
 2 1/2" - 4" 150 psi @ 73°F



PVC TRUE UNION

Threaded

Seats: HDPE
 O-rings: EPDM
 1/2" - 2" 240 psi @ 73°F
 2 1/2" - 4" 150 psi @ 73°F

Size	Reference	psi	Pack	Weight (lb)	Q	Code
1/2"	MA2001	240	B	7.77	24	MA2001
3/4"	MA2002	240	B	7.28	16	MA2002
1"	MA2003	240	B	6.69	10	MA2003
1 1/4"	MA2004	240	B	6.01	6	MA2004
1 1/2"	MA2005	240	D	24.86	16 (8)	MA2005
2"	MA2006	240	D	28.38	12	MA2006
2 1/2"	MA2007	150	D	23.98	4 (1)	MA2007
3"	MA2008R	150	D	25.30	4 (1)	MA2008R
4"	MA2010R	150	D	20.31	2 (1)	MA2010R

Size	Reference	psi	Pack	Weight (lb)	Q	Code
1/2"	MA2011	240	B	7.98	24	MA2011
3/4"	MA2012	240	B	7.48	16	MA2012
1"	MA2013	240	B	6.84	10	MA2013
1 1/4"	MA2014	240	B	6.17	6	MA2014
1 1/2"	MA2015	240	D	25.54	16 (8)	MA2015
2"	MA2016	240	D	29.26	12	MA2016
2 1/2"	MA2017	150	D	23.76	4 (1)	MA2017
3"	MA2018R	150	D	26.18	4 (1)	MA2018R
4"	MA2020R	150	D	20.94	2 (1)	MA2020R