

**TRUE UNION CHECK VALVES - SPRING SERIES**

**FEATURES**

- 100% factory tested.
- Easy installation and maintenance.
- May be used either vertically and horizontally.
- Available in PVC.
- Resistance to many inorganic chemicals.
- Excellent flow characteristics.
- Sizes from 1/2" - 4".
- Available standards: ANSI/ASTM, Metric, British Standard.
- Threaded versions: NPT and BSP.
- O-rings available in EPDM or Viton®.

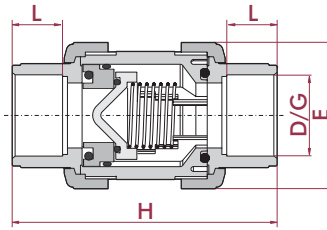

D / G	L	H	E
1/2"	0.6"	3.3"	2.0"
3/4"	0.7"	4.3"	2.4"
1"	0.9"	4.7"	2.8"
1 1/4"	1.0"	5.6"	3.3"
1 1/2"	1.2"	6.4"	3.7"
2"	1.5"	7.6"	4.6"
2 1/2"	1.7"	9.1"	5.8"
3"	2.0"	10.6"	7.0"
4"	2.4"	11.0"	7.0"

Fig.	Parts	Material
1	Body	PVC
2	Cone	PVC
3	Spring	AISI 302 st. steel
4	Union nut	PVC
5	End connector	PVC
6	Cone o-ring	PVC
7	Body o-ring	EPDM / FPM
8	End connector o-ring	EPDM / FPM
9	Seal carrier	PVC
10	Foot valve screen	PPL

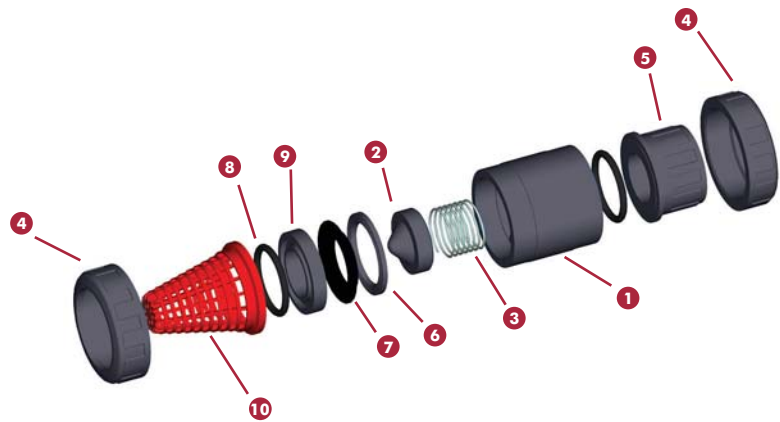

$$C_v = K_{v,100} / 14,28$$

$$K_{v,100} \text{ (l/min, } \Delta p = 1 \text{ bar)}$$

$$C_v \text{ (GPM, } \Delta p = 1 \text{ psi)}$$

D / G	K <sub>v,100</sub>	C <sub>v</sub>
1/2"	68	5
3/4"	133	9
1"	208	15
1 1/4"	383	27
1 1/2"	667	47
2"	850	60
2 1/2"	1533	107

**PRESSURE-TEMPERATURE RELATIONSHIP GUIDE**

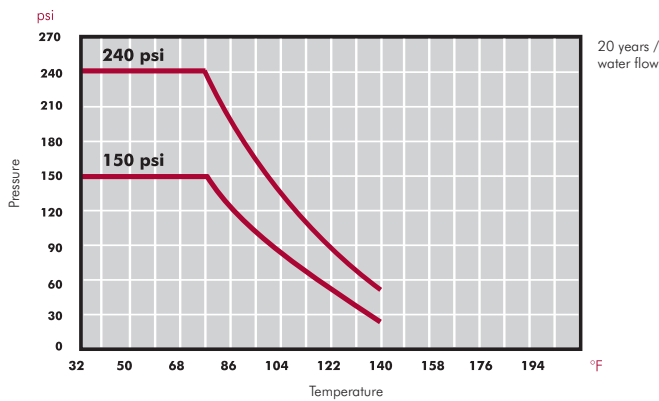

**TOTAL DYNAMIC HEAD**

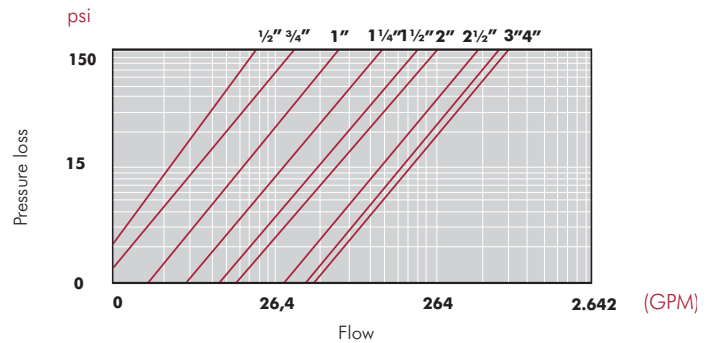

**PVC True Union Check Valves - Spring Series - EPDM**



**PVC TRUE UNION**  
**Socket and threaded**  
 O-rings: EPDM  
 1/2" - 2" 240 psi @ 73°F



**PVC TRUE UNION**<sup>1</sup>  
 O-rings: EPDM  
 2 1/2" - 4" 150 psi @ 73°F



Size	Reference	psi	Pack	Weight (lb)	Q	Code
1/2"	05 67 801 D	240	B	3.87	8 (1)	<b>22015</b>
3/4"	05 67 802 D	240	B	5.85	8 (1)	<b>22016</b>
1"	05 67 803 D	240	B	4.38	4 (1)	<b>22017</b>
1 1/4"	05 67 804 D	240	B	6.31	4 (1)	<b>22018</b>
1 1/2"	05 67 805 D	240	D	18.57	8 (1)	<b>22019</b>
2"	05 67 806 D	240	D	21.87	6 (1)	<b>22020</b>

**THREADED**

Size	Reference	psi	Pack	Weight (lb)	Q	Code
2 1/2"	05 67 807 R	150	D	24.60	4 (1)	<b>22071</b>
3"	05 67 808 R	150	D	19.29	2 (1)	<b>22075</b>
4" <sup>3</sup>	05 67 810 R	150	D	23.83	2 (1)	<b>24301</b>

**SOCKET**

Size	Reference	psi	Pack	Weight (lb)	Q	Code
2 1/2"	05 67 907 MAR	150	D	24.69	4 (1)	<b>22072</b>
3"	05 67 908 MAR	150	D	18.74	2 (1)	<b>22076</b>
4" <sup>3</sup>	05 67 910 MAR	150	D	22.98	2 (1)	<b>24302</b>

**PVC Double Union Check Valves - Spring Series - Viton®**



**PVC TRUE UNION**  
**Threaded and socket**  
 O-rings: FPM (Viton®)  
 1/2" - 2" 240 psi @ 73°F

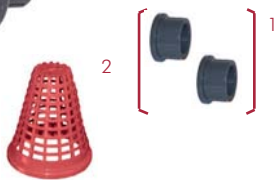

**PVC TRUE UNION**<sup>1</sup>  
 O-rings: FPM (Viton®)  
 2 1/2" - 4" 150 psi @ 73°F



Size	Reference	psi	Pack	Weight (lb)	Q	Code
1/2"	05 67 801 VID	240	B	3.91	8 (1)	<b>22015VIT</b>
3/4"	05 67 802 VID	240	B	5.92	8 (1)	<b>22016VIT</b>
1"	05 67 803 VID	240	B	4.43	4 (1)	<b>22017VIT</b>
1 1/4"	05 67 804 VID	240	B	6.56	4 (1)	<b>22018VIT</b>
1 1/2"	05 67 805 VID	240	D	18.29	8 (1)	<b>22019VIT</b>
2"	05 67 806 VID	240	D	22.74	6 (1)	<b>22020VIT</b>

**THREADED**

Size	Reference	psi	Pack	Weight (lb)	Q	Code
2 1/2"	05 67 807 VIR	150	D	24.88	4 (1)	<b>22071VIT</b>
3"	05 67 808 VIR	150	D	21.50	2 (1)	<b>22075VIT</b>
4" <sup>3</sup>	05 67 810 VIR	150	D	24.11	2 (1)	<b>24301VIT</b>

**SOCKET**

Size	Reference	psi	Pack	Weight (lb)	Q	Code
2 1/2"	05 67 907 AVR	150	D	24.97	4 (1)	<b>22072VIT</b>
3"	05 67 908 AVR	150	D	20.24	2 (1)	<b>22076VIT</b>
4" <sup>3</sup>	05 67 910 AVR	150	D	23.24	2 (1)	<b>24302VIT</b>

<sup>1</sup> 1/2" thru 2" Ball Valves are supplied with both socket and threaded end connectors.

<sup>2</sup> 1/2" thru 4" Ball Valves have to be ordered with socket or threaded connections, they don't include both.

<sup>2</sup> Check Valves are supplied with a foot valve screen; used to convert true union ball check valves into foot valves.

<sup>3</sup> 3" double union body venturied to 4"