

WAFER CHECK VALVES

FEATURES

- Requires little space in piping systems.
- Easy installation: wafer body slips between standard flanges. No gaskets required.
- Vertical and horizontal operation.
- Available with EPDM o-rings.
- Excellent flow characteristics.
- Sizes from 4" - 8".
- Available Standards: ANSI/ASTM, ISO/DIN.

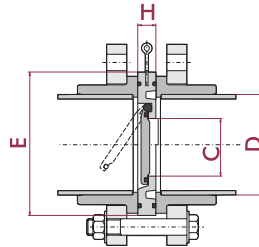

D	C	H	E	M x L
4"	2.8"	0.9"	6.5"	0.6" x 4.7"
6"	4.4"	1.0"	8.7"	0.8" x 6.3"
8"	5.5"	1.1"	9.7"	0.8" x 6.3"

Do not install the valve at a distance closer to 5 pipe diameters from the pump discharge. Install with ANSI 150 pound flanges.

- Minimum return pressure: 3 psi.

Fig.	Parts	Material
1	Body	PVC
2	Flap	PVC
3	Cap	PPL
4	Body o-ring	EPDM
5	Flap o-ring	EPDM

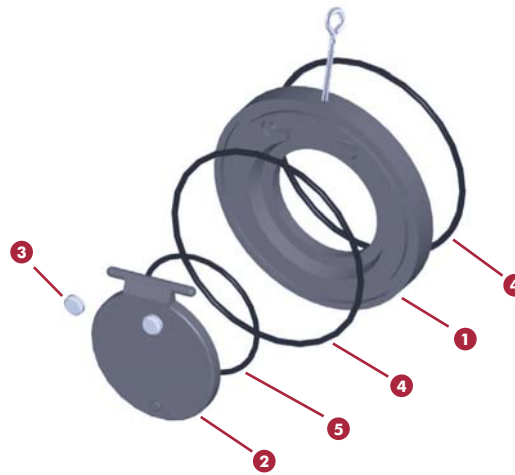

D	Cv
4"	126
6"	655
8"	1085

$C_v = K_v_{100} / 14,28$
 $K_v_{100} (l/min, \Delta p = 1 \text{ bar})$
 $C_v (GPM, \Delta p = 1 \text{ psi})$

PRESSURE-TEMPERATURE RELATIONSHIP GUIDE

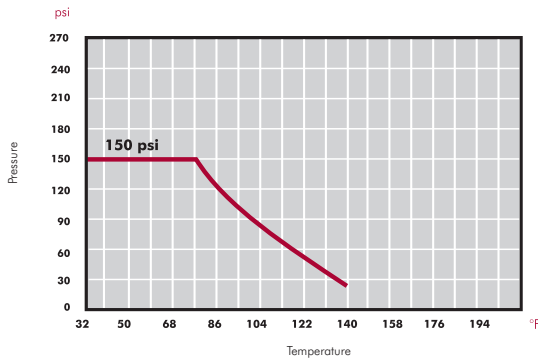

TOTAL DYNAMIC HEAD

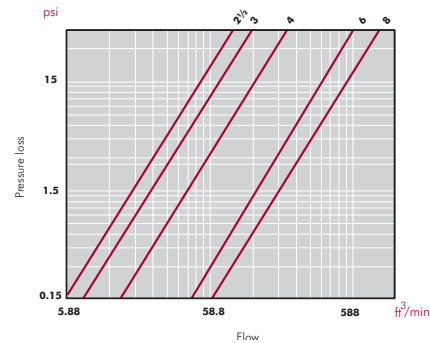

PVC
 O-rings: EPDM
 150 psi @ 73°F

Size	Reference	psi	Pack	Weight (lb)	Q	Code
4"	05 65 110	150	B	6.27	5	08986
6"	05 65 160	150	C	12.83	5	08988
8"	05 65 225	150	C	12.98	4	08989