

GF Piping Systems Datasheet

Wafer Check Valves

Type 369 Wafer Check Valve PVC Without spring

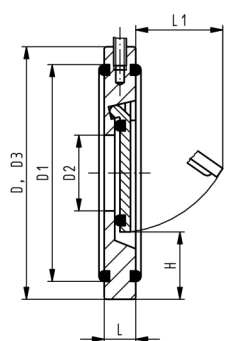

Model:

- Supporting eyelets for simple fitting
- Suitable for vertical and horizontal mounting

Installation instruction:

- Installation between ISO/DIN (all dimensions) and ANSI flange adaptors (all except DN32 and DN125)
- Installation with ANSI flange adaptor: for wafer check valves 1 1/2" to 3", use ANSI flange adaptors with the next bigger dimension (example: 1 1/2" wafer check valve between 2" ANSI flange adaptor)
- Centering by body diameter (ISO/DIN by D3, ANSI by D)
- Sealing with O-rings
- A stabilizing zone of at least 5 times nominal diameter should be provided before and after the wafer check valve
- Do not install on pump flange
- The using of PVC-U pipe PN16 is only possible up to d63
- Wafer check valves without reset spring are not recommended for pulsating flows (production of noise)

d [mm]	DN [inch]	Size	PN	EPDM Part No.	CFM	FPM Part No.	CFM	lbs
40	1.26	1 ¼	90	161 369 002	239 83 24	161 369 022		0.287
50	1.57	1 ½	90	161 369 003	239 83 25	161 369 023		0.353
63	1.97	2	90	161 369 004	239 83 26	161 369 024		0.551
75	2.56	2 ½	90	161 369 005	239 83 27	161 369 025		0.705
90	3.15	3	90	161 369 006	239 83 28	161 369 026		0.860
110	3.94	4	90	161 369 007	239 83 29	161 369 027		1.213
140	4.92	5	90	161 369 009	239 83 31	161 369 029		1.653
160	5.91	6	90	161 369 010	239 83 32	161 369 030		2.425
225	7.87	8	90	161 369 011	239 83 33	161 369 031		4.630
280	9.84	10	90	161 369 012	239 83 34	161 369 032		7.716
315	11.81	12	90	161 369 013	239 83 35	161 369 033		11.684

d [mm]	D [inch]	D1 [inch]	D2 [inch]	D3 [inch]	L [inch]	L1 [inch]	H [inch]	Opening pressure vertical [mbar]	Opening pressure horizontal [mbar]
40	3.35	2.32	0.71	3.35	0.59	0.87	0.98	10	1
50	4.13	2.91	0.87	3.74	0.63	1.06	1.06	10	1
63	4.88	3.54	1.26	4.29	0.71	1.57	1.14	10	1
75	5.39	4.33	1.57	5.08	0.79	2.17	1.22	10	1
90	6.89	4.92	2.13	5.67	0.79	2.64	1.26	10	1
110	6.89	5.91	2.76	6.46	0.91	2.64	1.22	10	1
140	7.68	7.01	3.62	7.68	0.91	3.70	1.38	10	1
160	8.74	7.56	4.13	8.66	1.02	3.94	1.61	10	1
225	10.98	10.08	6.06	10.83	1.38	5.98	1.50	18	1
280	13.39	12.05	7.56	12.99	1.57	7.09	1.61	18	1
315	16.14	13.46	8.94	14.96	1.77	8.46	1.61	18	1

GF Piping Systems Datasheet

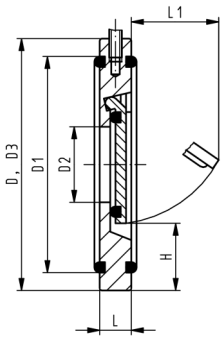

d [mm]	Minimum water column for sealing [ft]	close st inch	
40	6.56	1 ¼	
50	6.56	1 ½	
63	6.56	2	
75	6.56	2 ½	
90	6.56	3	
110	6.56	4	
140	6.56	5	
160	6.56	6	
225	6.56	8	
280	6.56	10	
315	6.56	12	

The technical data are not binding and not expressly warranted characteristics of the goods. They are subject to change. Our General Conditions of Sale apply.

Authorized Distributor:

Aetna Plastics Corp. 1702 St. Clair Ave. Cleveland, Ohio 44114 • Tel: 800-634-3074
216-781-4421 • Fax: 216-781-4474 • sales@aetnaplastics.com • www.aetnaplastics.com